

Illustrated Index

Torque	Bolt size
A— 8 N·m (0.8 kg-m, 6 lb-ft)	1— 5 x 0.8 mm
B— 12 N·m (1.2 kg-m, 9 lb-ft)	2— 6 x 1.0 mm
C— 14 N·m (1.4 kg-m, 10 lb-ft)	3— 8 x 1.25 mm
D— 18 N·m (1.8 kg-m, 12 lb-ft)	
E— 27 N·m (2.7 kg-m, 20 lb-ft)	
F— 29 N·m (2.9 kg-m, 21 lb-ft)	
G— 40 N·m (4.0 kg-m, 29 lb-ft)	
H— 95 N·m (9.5 kg-m, 70 lb-ft)	

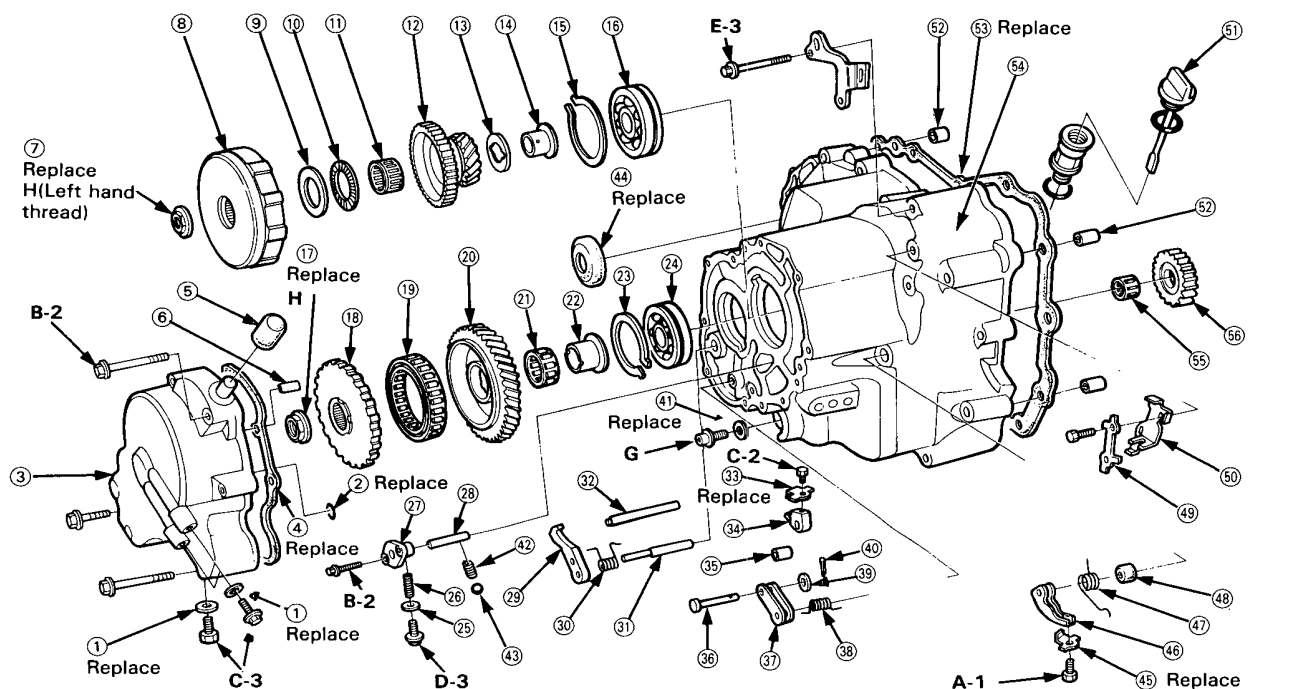

- ① WASHER 8 mm
- ② O-RING 6 x 2.3 mm
- ③ END COVER
Disassembly/Inspection,
page 16-48
- ④ GASKET
- ⑤ BREATHER CAP
- ⑥ DOWEL PIN 8 x 14 mm
- ⑦ LOCK NUT
Removal, page 16-13
Installation, page 16-59
- ⑧ 1st CLUTCH
Removal, page 16-13
Disassembly, page 16-37
Reassembly, page 16-41
- ⑨ THRUST WASHER 26 mm
- ⑩ THRUST NEEDLE
BEARING 31 x 47 x 2 mm
- ⑪ NEEDLE BEARING
31 x 36 x 18.5 mm
- ⑫ MAINSHAFT 1st GEAR

- ⑬ THRUST WASHER
- ⑭ COLLAR 26 mm
- ⑮ SNAP RING 68 mm
- ⑯ MAINSHAFT BEARING
Replacement, page 16-45
- ⑰ LOCK NUT
Removal, page 16-13
Installation, page 16-59
- ⑱ PARKING GEAR
- ⑲ ONE-WAY CLUTCH
- ⑳ COUNTERSHAFT 1st GEAR
Disassembly/Inspection,
page 16-22
- ㉑ NEEDLE BEARING
- ㉒ 1st GEAR COLLAR
- ㉓ SNAP RING 62 mm
- ㉔ COUNTERSHAFT BEARING
- ㉕ WASHER 8 mm
- ㉖ SPRING
- ㉗ REVERSE IDLER
BEARING HOLDER
Removal, page 16-15

- ㉘ REVERSE GEAR SHAFT
- ㉙ PARKING PAWL
- ㉚ PARKING PAWL SPRING
- ㉛ PARKING PAWL SHAFT
- ㉜ STOP PIN
- ㉝ LOCK PLATE
- ㉞ PARKING LEVER
- ㉟ PARKING PAWL ROLLER
- ㊱ ROLLER PIN
- ㊲ PARKING SHIFT ARM
- ㊳ RETURN SPRING
- ㊴ WASHER 5 mm
- ㊵ COTTER PIN
- ㊶ WASHER 14 mm
- ㊷ SPRING
- ㊸ STEEL BALL
- ㊹ DIFFERENTIAL
OIL SEAL
Installation, page 16-45
- ㊺ LOCK PLATE
- ㊻ THROTTLE CONTROL
LEVER

- ㊼ THROTTLE CONTROL
SHAFT SPRING
Removal, page 16-15
Installation, page 16-57
- ㊽ THROTTLE CONTROL
SHAFT SEAL
- ㊾ LOCK PLATE
- ㊿ THROTTLE CONTROL
CABLE BRACKET
- 51 DIPSTICK
- 52 DOWEL PIN 14 x 25 mm
- 53 GASKET
- 54 TRANSMISSION HOUSING
- 55 NEEDLE BEARING
REVERSE IDLER GEAR
Replacement, page 16-56

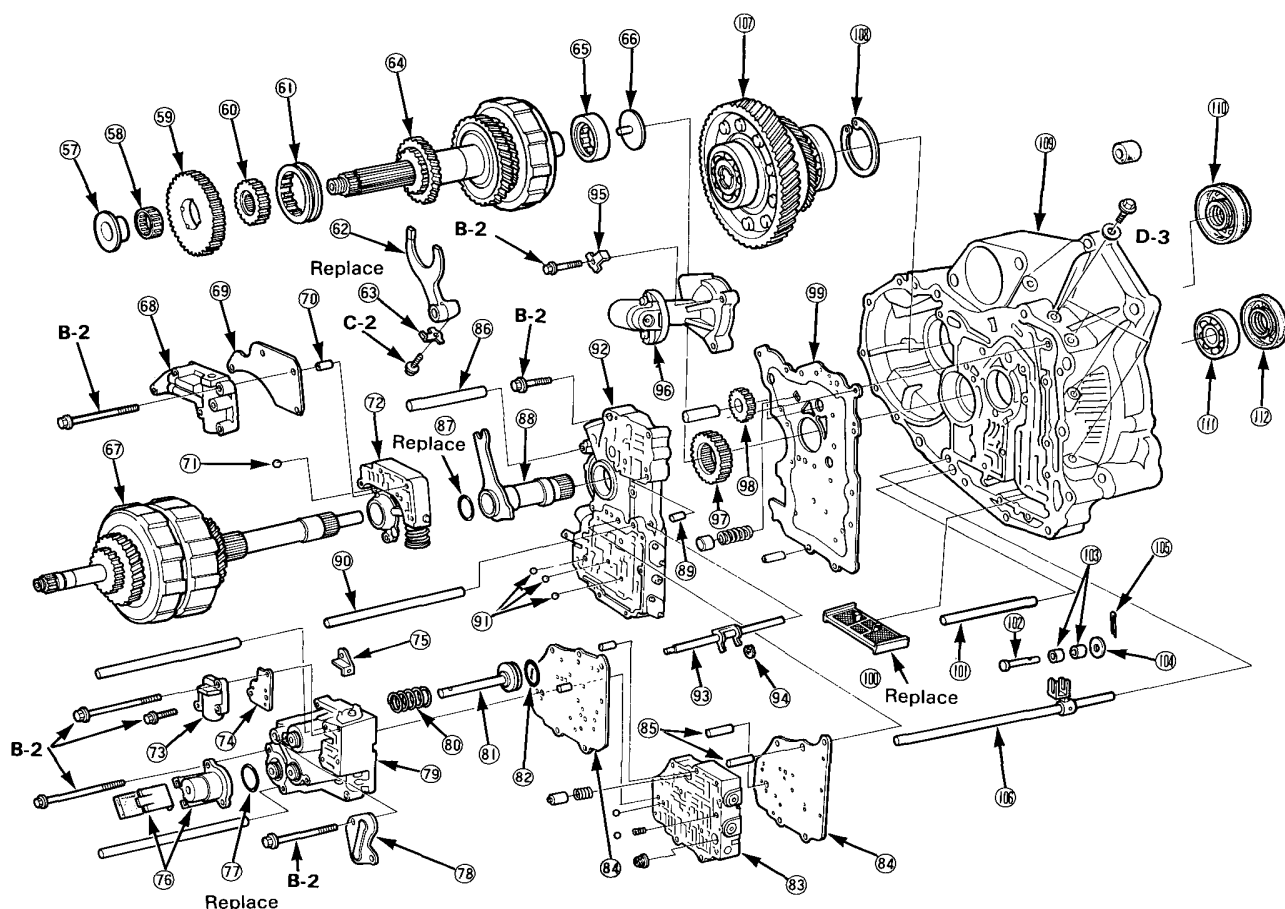

- 57 REVERSE GEAR COLLAR
- 58 NEEDLE BEARING
- 59 COUNTERSHAFT
- 60 REVERSE GEAR
- 61 SELECTOR HUB
- 62 REVERSE GEAR SELECTOR
- 63 REVERSE SHIFT FORK
- 64 LOCK PLATE
- 65 COUNTERSHAFT ASSY
Disassembly/Inspection, page 16-33
- 66 COUNTERSHAFT NEEDLE BEARING
- 67 OIL GUIDE PLATE
- 68 MAINSHAFT ASSY
Disassembly/Inspection page 16-32
- 69 LOCK UP SHIFT VALVE BODY
Removal, page 16-19
Disassembly, page 16-29
- 70 SEPARATOR PLATE

- 71 DOWEL PIN
- 72 STEEL BALL
- 73 REGULATOR VALVE BODY
Removal, page 16-19
Repair, page 16-25
Disassembly, page 16-28
- 74 MODULATOR VALVE BODY
Removal, page 16-18
- 75 SEPARATOR PLATE
- 76 CHECK VALVE STOP PLATE
- 77 4th ACCUMULATOR COVER
- 78 O-RING
- 79 2nd/3rd ACCUMULATOR COVER
- 80 SERVO VALVE BODY ASSY
Removal, 16-17
Disassembly, 16-30
- 81 RETURN SPRING
- 82 SERVO VALVE
- 83 O-RING 31 x 2.7 mm
- 84 SECONDARY VALVE BODY ASSY
Removal, 16-18
Disassembly/Inspect, 16-24

- 85 SEPARATOR PLATE
- 86 DOWEL PIN
- 87 STOP PIN
- 88 O-RING
- 89 STATOR SHAFT
- 90 DOWEL PIN
- 91 1st CLUTCH PIPE
- 92 STEEL BALLS
- 93 MAIN VALVE BODY ASSY
Remove, 16-20
Disassembly, 16-23
- 94 THROTTLE CONTROL SHAFT
- 95 E-CLIP
- 96 LOCK PLATE
- 97 GOVERNOR VALVE
Removal, 16-17
Disassembly/Inspection, 16-31
- 98 PUMP DRIVE GEAR
- 99 PUMP DRIVEN GEAR
- 100 MAIN VALVE SEPARATOR PLATE

- 101 FILTER SCREEN
- 102 SUCTION PIPE
- 103 MANUAL VALVE PIN
- 104 ROLLER
- 105 WASHER 5 mm
- 106 COTTER PIN
- 107 CONTROL SHAFT
- 108 DIFFERENTIAL
- 109 SNAP RING 80 mm
- 110 TORQUE CONVERTER HOUSING
- 111 DIFFERENTIAL OIL SEAL
- 112 MAINSHAFT BEARING
- 113 MAINSHAFT OIL SEAL